

MONTAGEANLEITUNG

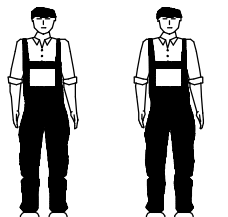

2 Pers. t= 20min

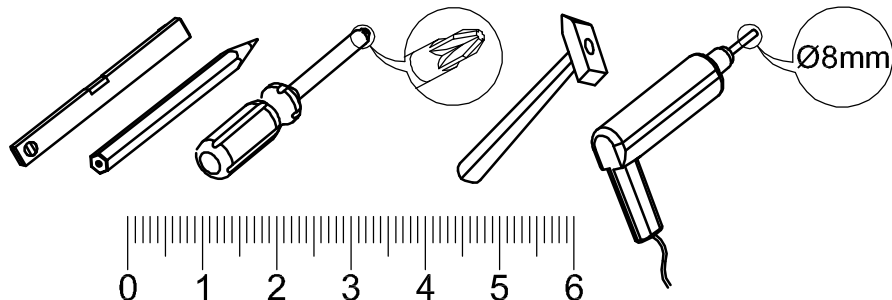

WANDBOARD (COX1QT50)

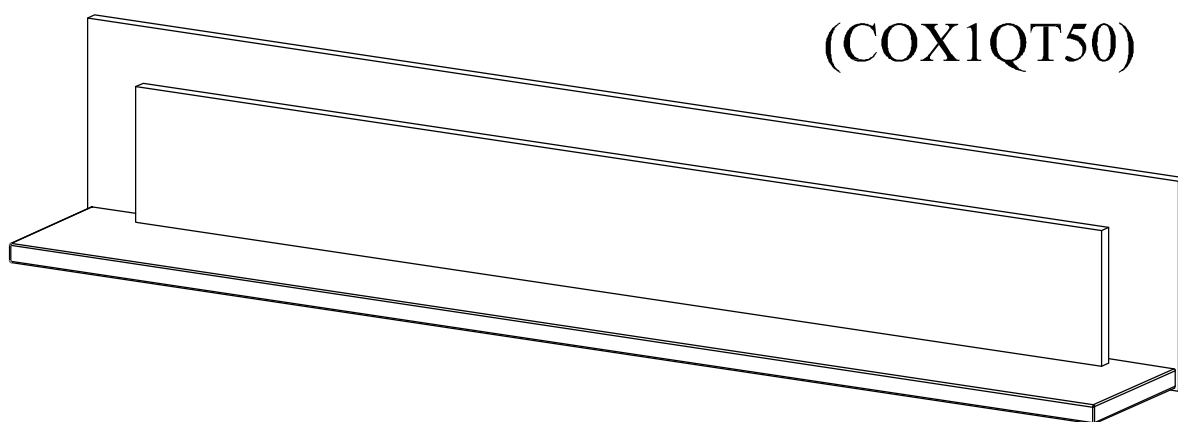

PACKSTUCK INHALT

COLLI 1/1	
A	1390 x 240 x 18
B	1150 x 115 x 16
C	1230 x 155 x 16
D	1382 x 180 x 22

BESCHLÄGLISTE

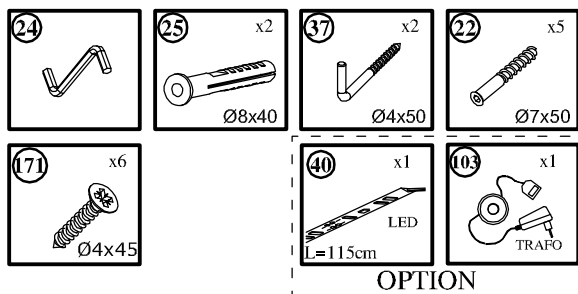

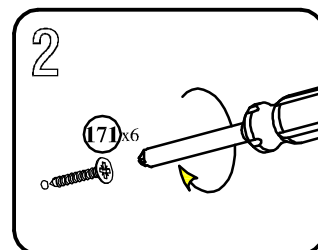
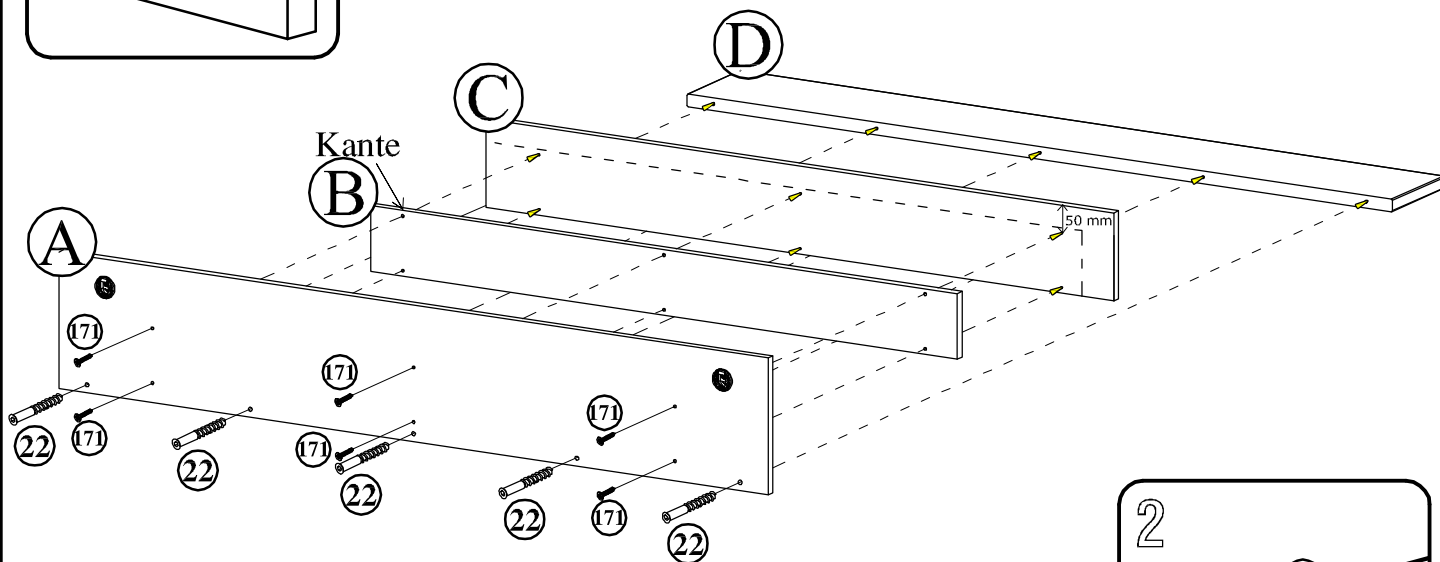
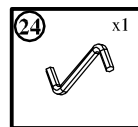
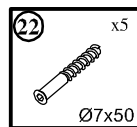
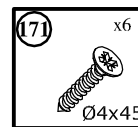
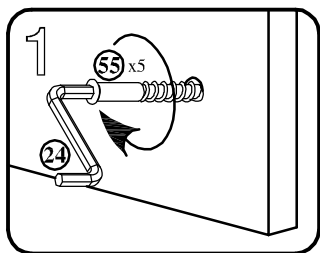

OPTION

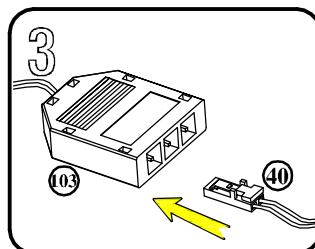
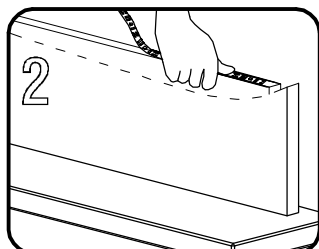
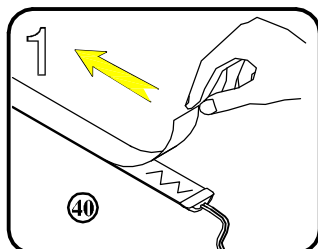
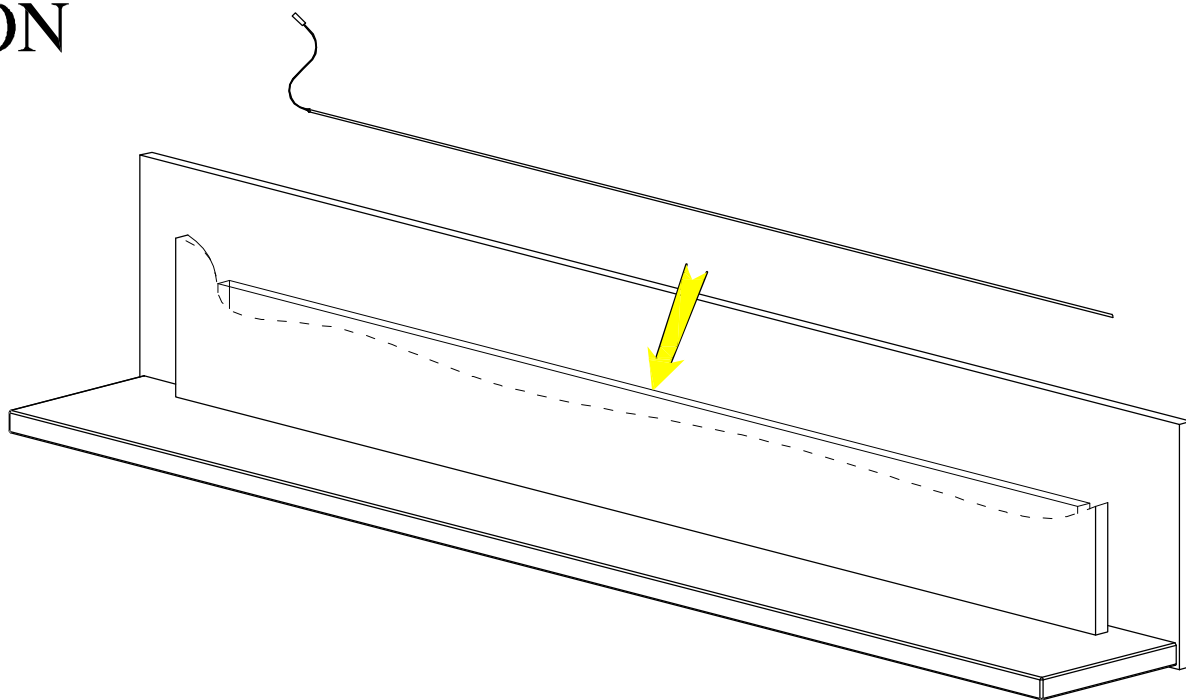
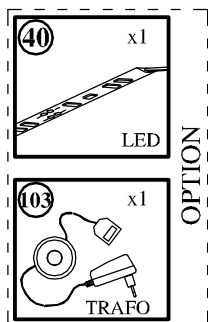

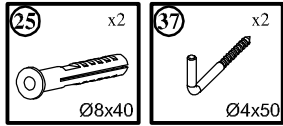

! ACHTUNG !
MAX . BELASTUNG
DER BODEN 3 kg

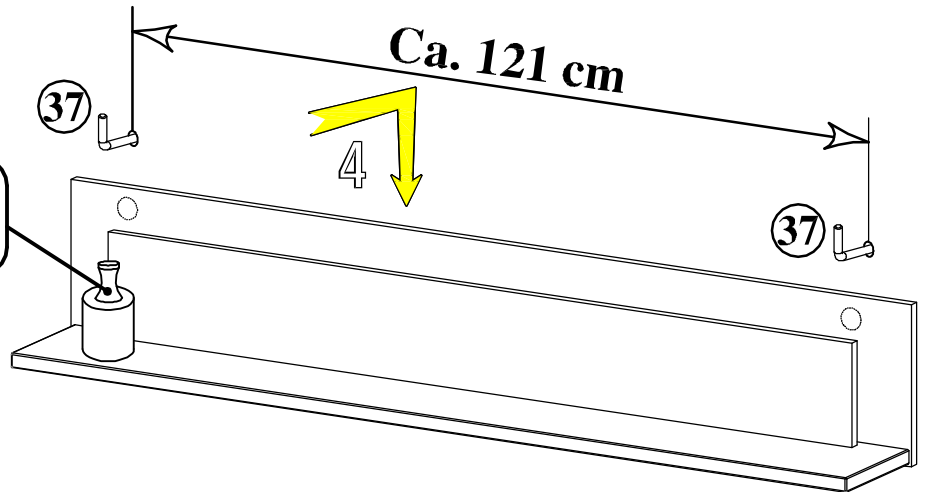

Die beigefügten Dübel zum Aufhängen des Elements dürfen nur bei Betonwänden eingesetzt werden, bei anderen Wandarten müssen entsprechende Dübel zugekauft werden.

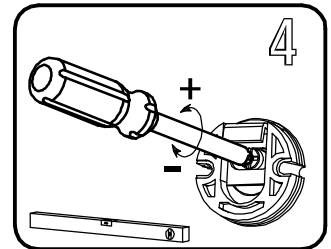
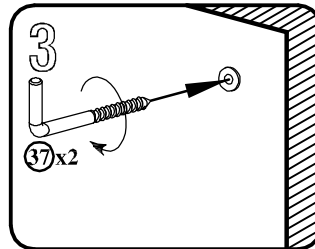
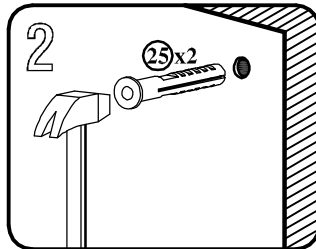
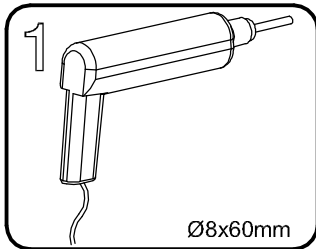

Ca. 19,8 cm

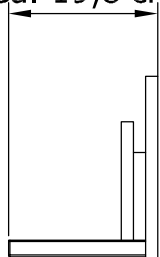

Ca. 139,0 cm

