

MONTAGEANLEITUNG

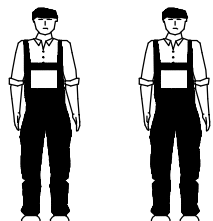

2 Pers. t= 20min

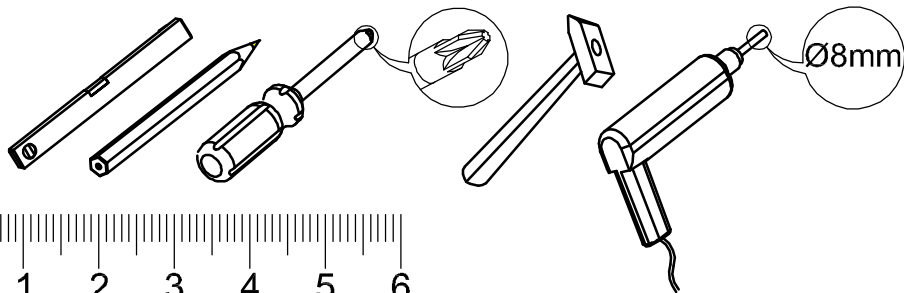

TV - ELEMENT (COXTQT32)

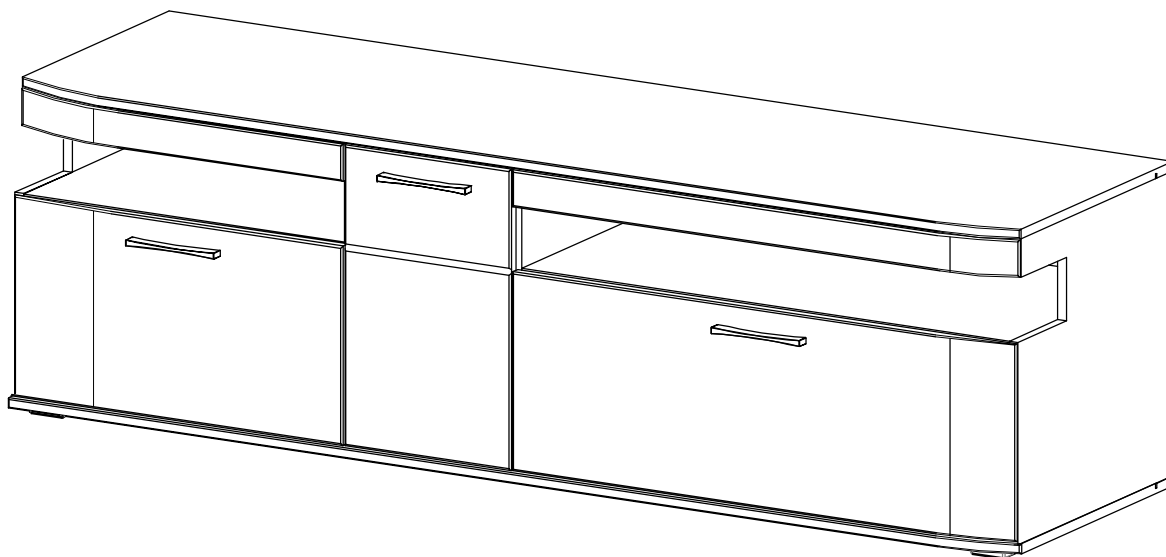

BESCHLÄGLISTE

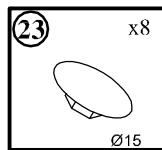
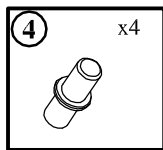
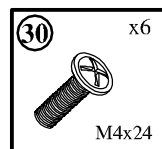
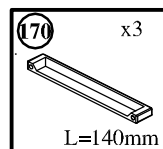
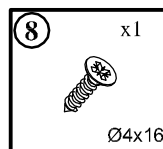
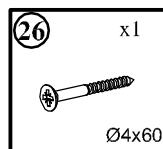
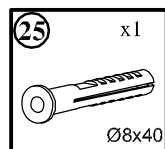
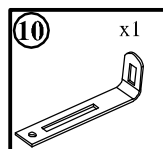
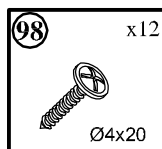
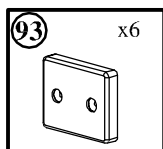

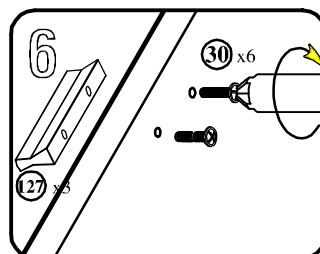
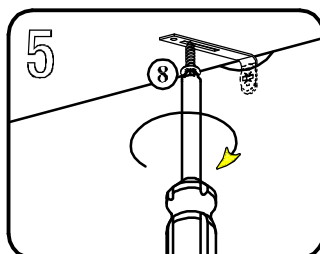
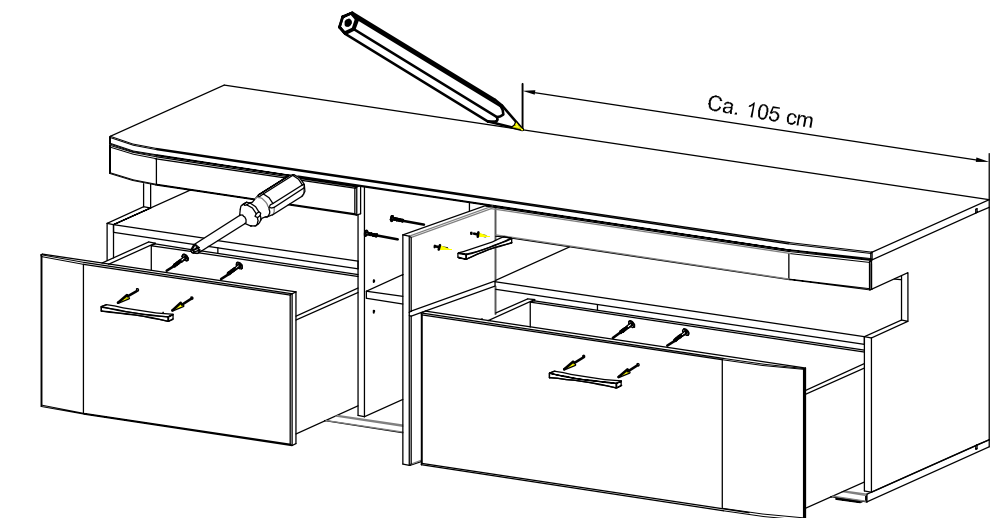
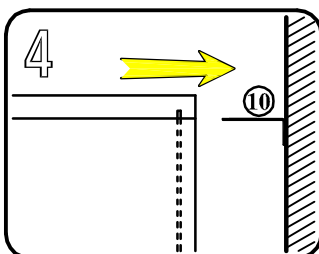
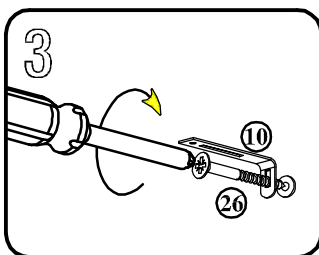
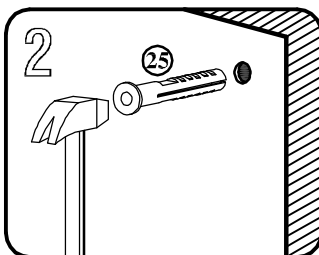
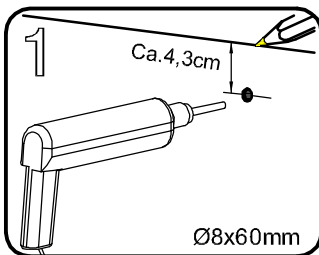
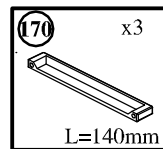
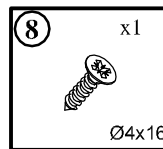
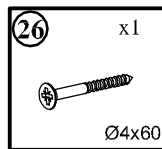
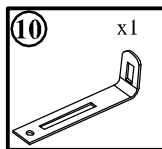
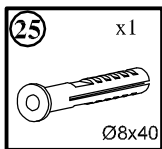
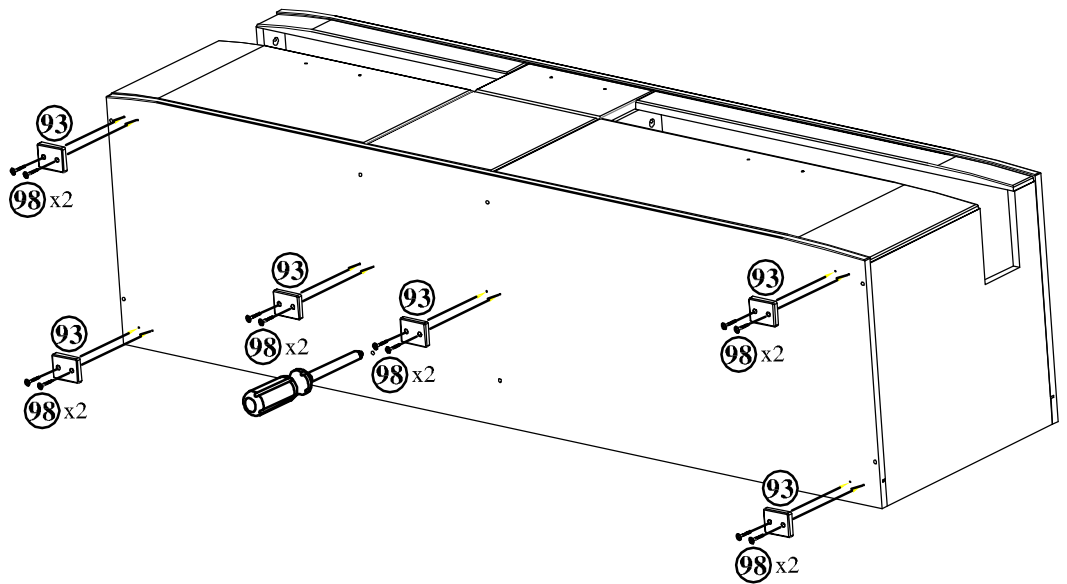
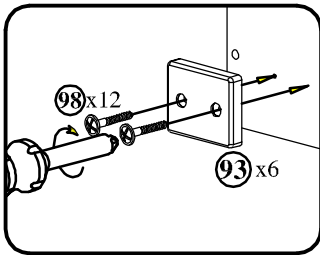
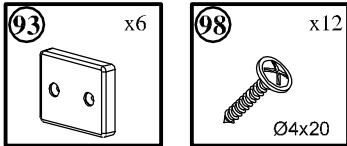

Die beigelegten Dübel zum Aufhängen des Elements dürfen nur bei Betonwänden eingesetzt werden, bei anderen Wandarten müssen entsprechende Dübel zugekauft werden.

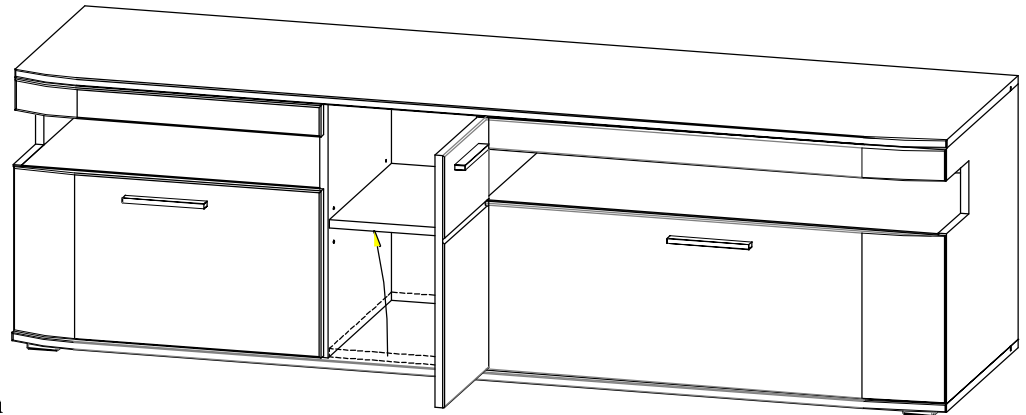
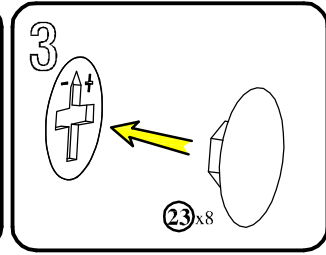
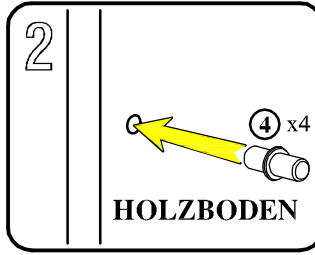
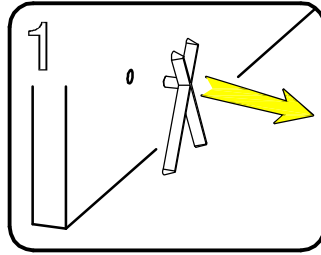
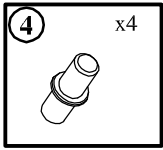
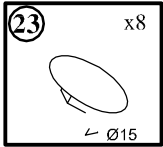

Pflegehinweis !

Bitte nur mit einem Staubtuch oder einem feuchten Lappen reinigen.

KEINE scheuernde Putzmittel verwenden !

! ACHTUNG !
MAX . BELASTUNG 30 kg

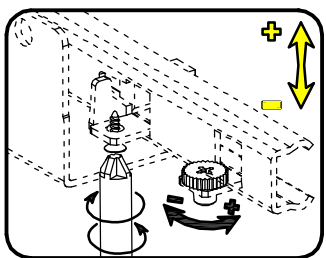
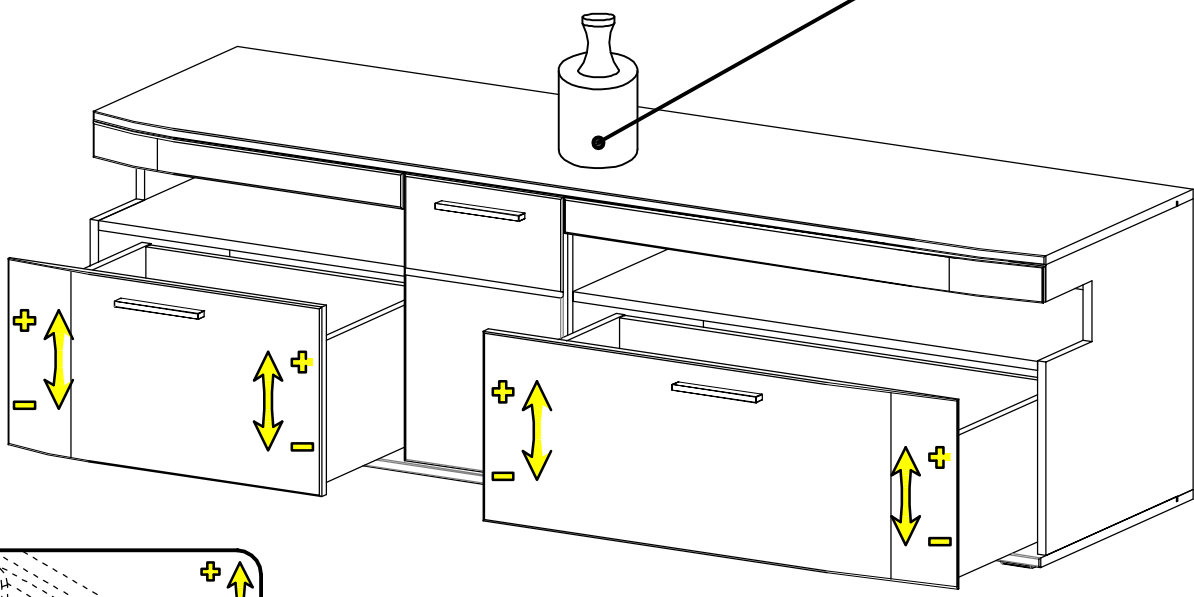

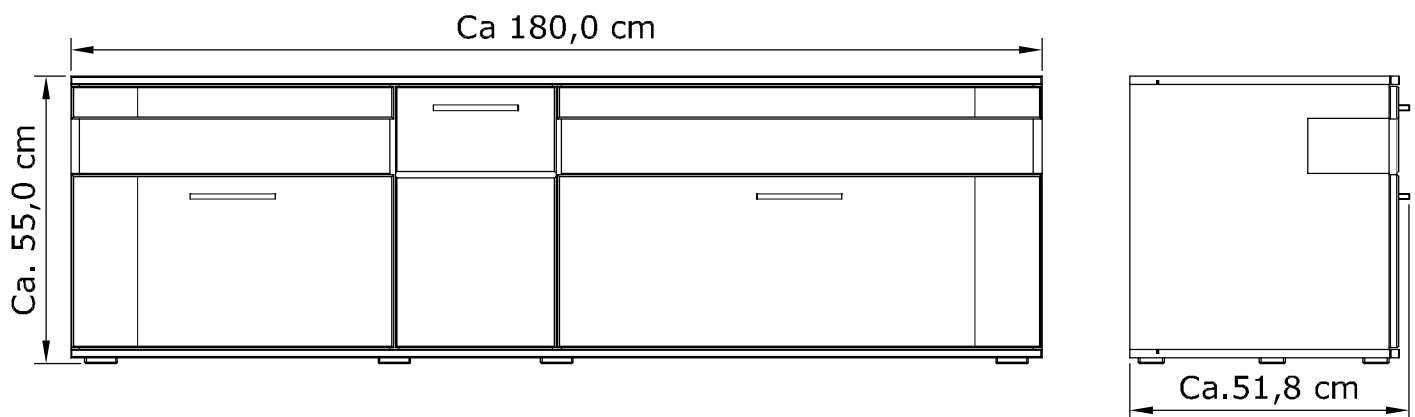

a)
Fugenverstellung:

Befestigungsschraube "A" lockern,
gewünschte Fuge mit Schraube "B"
einstellen. Schraube "A" anziehen.

Verstellmöglichkeiten

b)
Tiefenverstellung:

Befestigungsschraube "A" lockern,
Bandarm nach voren oder
rückwärts verschieben, Schraube "A"
anziehen, Schraube "B" mit
einer 1/4 Drehung nach rechts
arretieren.

c)
Hohenverstellung:

Befestigungsschraube "C" lockern,
Hohe einstellen, Schraube "C"
anziehen.

